

# ENVIRO CERAMIC MICRO BUBBLE DIFFUSER SPECIFICATIONS

- ✓ Superior Technology
- ✓ Durable Quality
- ✓ Affordable Prices
- ✓ Worldwide Distribution by our team of experts

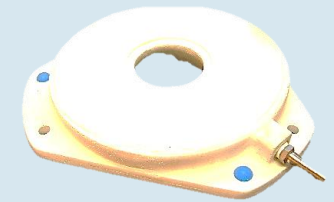
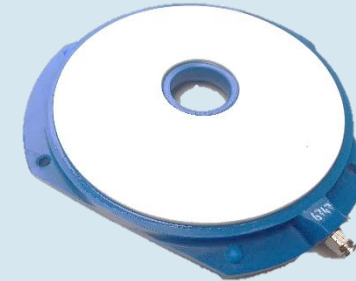

<b>Application:</b>	For Fish Farming as oxygen supplement, emergency backup, hatcheries and transportation.			Ozone water treatment & sterilisation.
<b>Model Number:</b>	<b>ECD 100</b>	<b>ECD 200</b>	<b>ECD 400</b>	<b>ECO<sub>3</sub>D 200</b>
<b>Ceramic Diffusing Area:</b>	100 cm <sup>2</sup> / 16 in <sup>2</sup>	200 cm <sup>2</sup> / 31 in <sup>2</sup>	400 cm <sup>2</sup> / 62 in <sup>2</sup>	200 cm <sup>2</sup> / 31 in <sup>2</sup>
<b>Oxygen Delivered at below 3.5 bar 50 psi</b>	120g/hr@1.5LPM	240 g/hr @ 3 LPM	480 g/hr @ 6 LPM	320 g O <sub>3</sub> /hr @ 3 LPM
<b>Recommended Operating Range for optimum bubble size/efficiency:</b>	0.75 to 1.5 L/min @ <2.5 bar 1.6 to 3.2 ft3/hr @ <36 psi	1.5 to 3 L/min @ <2.5 bar 3.2 to 6.4 ft3/hr @ <36 psi	3 to 6 L/min @ <2.5 bar 6.4 to 12.8 ft3/hr @ <36 psi	1.5 to 3 L/min @ 0.3-0.7 bar 3.2 to 6.4 ft3/hr @ 4 to 10 psi
<b>Maximum Operating Pressure:</b>	Do not exceed 3.5 bar/ 50 psi, regulate flow with Flow Meter/Rotameter			1.5 bar / 22 psi
<b>Size/Dimensions:</b>	Ø174 x 35 mm high	Ø225 x 35 mm high	Ø292 x 40 mm high	Ø225 x 40 mm high
<b>Nett Weight:</b>	0.7 kg / 1.5 lbs	1.35 kg / 3.0 lbs	2.6 kg / 5.7 lbs	1.7 kg / 3.7 lbs
<b>Ceramic Pore Size/ Bubble Size:</b>	Pores avg. 0.5 micron (500 nano metres) / bubbles avg. 120 µm (<0 to 200 µm) at recommended operating range			Pores avg.0.5 µm/bubbles <50 to 250 µm at recommended operating range
<b>Gas inlet connection Fittings:</b>	Use a 1/4" NPT thread male fitting for your gas hose connector. Our diffuser fitting is a 1/4" female NPT thread 316L SS.			Supplied with a 316L SS Hose Barb 1/8" NPT male for a Ø6-7 mm hose
<b>Materials of manufacture:</b>	Inert anti-biofouling nano porous ceramic membrane with a tough polyurethane resin housing, silicone and marine grade 316L stainless-steel fittings.			100% inert ceramic with silicone and 316L stainless steel. Ozone Resistant.

- ✓ Anti-Biofouling inert ceramic: protecting the working surface and inside from algae growth, reduces maintenance and risk of blocked pores.
- ✓ Unique design with patented central hole causes water stream to mix with the air lift for additional aeration efficiency.
- ✓ Nano sized pores result in the finest bubbles possible and reliable gas transfer.